



# CITY OF SOUTH LAKE TAHOE

Development Services Department, Planning Division

1052 Tata Lane, South Lake Tahoe, CA 96150

Phone (530) 542-6010 • Fax (530) 541-7524

Web address: [www.cityofslt.us/](http://www.cityofslt.us/)

## FENCE PERMIT APPLICATION

Submittal Date: \_\_\_\_\_

Permit Number: \_\_\_\_\_

Review the location, standards of construction, and maintenance of fences to ensure the health, safety, and welfare of the general public are not significantly harmed. Please submit completed application to address above or via e-mail: [Planner@cityofslt.us](mailto:Planner@cityofslt.us)

### APPLICANT INFORMATION

*The applicant(s) will be considered the primary point(s) for correspondence and contact from the City unless otherwise requested in writing.*

Site Address: \_\_\_\_\_ Assessor Parcel Number: \_\_\_\_\_

Name(s): \_\_\_\_\_ Phone #: \_\_\_\_\_

Mailing Address: \_\_\_\_\_ City: \_\_\_\_\_ State: \_\_\_\_\_ Zip: \_\_\_\_\_

Email Address: \_\_\_\_\_

### PROPERTY OWNER INFORMATION

Property owner(s) same as above: \_\_\_\_\_  
*(skip this section if same as above)*

Name(s): \_\_\_\_\_ Phone #: \_\_\_\_\_

Mailing Address: \_\_\_\_\_ City: \_\_\_\_\_ State: \_\_\_\_\_ Zip: \_\_\_\_\_

Email Address: \_\_\_\_\_

### FENCE INFORMATION

Residential standard fence

Commercial standard fence

Residential alternative fence

Commercial alternative fence

### APPLICATION SUBMITTAL REQUIREMENTS

Each application shall contain the following information; some applications may require additional information. Consult with a Permit Technician to determine whether additional materials are required. If any required information is not provided, the application will not be accepted.

- Completed Fence Application containing the applicant(s) and property owner(s) signature(s) and type of fence requested
- Site Plan showing all property lines, existing structures, driveways, parking areas, existing fences and the proposed fence
- Description of the fence height, materials, size of lumber, spacing of posts, etc.

*I hereby declare under penalty of perjury that this application and all information submitted as part of this application are true and accurate to the best of my knowledge. I am the owner(s) of the subject property or have been authorized to represent the owner on this application as the applicant. I understand that should any information or representation be submitted in connection with this application be incorrect or untrue, the City may rescind any approval or take other appropriate action.*

**Applicant(s) Signature(s):** \_\_\_\_\_ **Date:** \_\_\_\_\_

**Property Owner(s) Signature(s):** \_\_\_\_\_ **Date:** \_\_\_\_\_



# CITY OF SOUTH LAKE TAHOE

Development Services Department, Planning Division

1052 Tata Lane, South Lake Tahoe, CA 96150

Phone (530) 542-6010 • Fax (530) 541-7524

Web address: [www.cityofslt.us/](http://www.cityofslt.us/)

## STAFF USE ONLY

Site Address: \_\_\_\_\_ APN: \_\_\_\_\_ Permit Number: \_\_\_\_\_

Fees Paid: \_\_\_\_\_ Received By: \_\_\_\_\_ Date: \_\_\_\_\_

Is any of the property within a Stream Environment Zone?  YES  NO

### DECISION

Based on the above review, the Fence Application is:

- Approved with no conditions
- Approved with conditions: \_\_\_\_\_  
\_\_\_\_\_
- Denied

Planner Signature: \_\_\_\_\_ Date: \_\_\_\_\_

## INSPECTION

A final inspection is required once the fence is constructed. **Please call (530) 542-6010 to schedule an inspection.** Please note you do not need to be available during the inspection, as staff will inspect as workload allows.

**\*\* If a final inspection is not completed within 6 months of permit issuance, you may be subject to an administrative citation.**

## APPROVAL SIGNATURES

I have read and understand the applicable requirements and standards contained in sections 6.10 and 7.05.520 of the City Code, the conditions of approval, if any, and agree to comply with them.

**Applicant(s) Signature(s):** \_\_\_\_\_ **Date:** \_\_\_\_\_

I understand that it is my responsibility to determine all property lines. I assume all liability in regard to property line disputes and any claim in regard to snow removal.

**Property Owner(s) Signature(s):** \_\_\_\_\_ **Date:** \_\_\_\_\_

**Sample Site Plan:**

EXAMPLE of a SITE PLAN  
for a standard fence

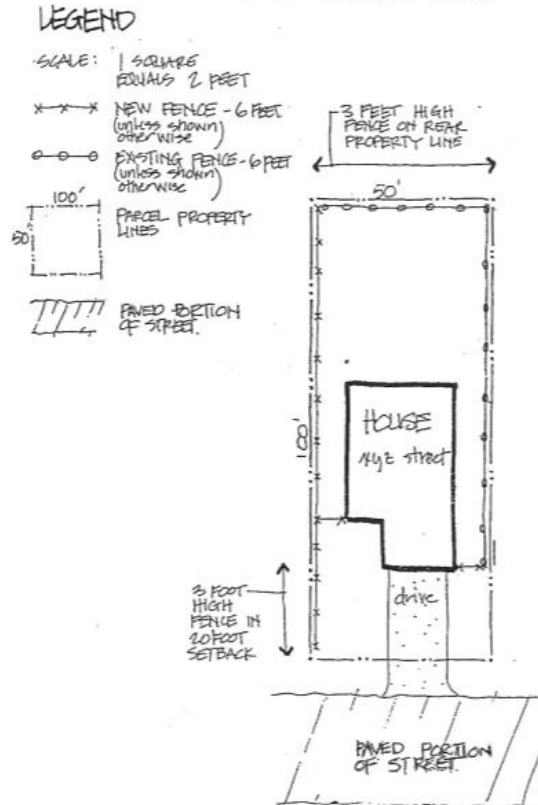

**Applicant Site Plan:**



# ONE TIME CREDIT CARD PAYMENT AUTHORIZATION FORM

*Credit Card Authorization Form may be used for immediate project intake.*

*Fees may alternatively be calculated by staff at intake. Project cannot be taken in until fees are collected. For assistance in calculating your fees prior to project submittal, please contact the Permit Center.*

ADDRESS OF PROPERTY \_\_\_\_\_

APN \_\_\_\_\_ UNIT # \_\_\_\_\_

Sign and complete this form to authorize City of South Lake Tahoe to make a one-time debit to your credit card listed below.

By signing this form, you give us permission to debit your account for the amount indicated on or after the indicated date. This is permission for a single transaction only and does not provide authorization for any additional unrelated debits or credits to your account.

**Please complete the information below:**

I, \_\_\_\_\_, authorize **City of South Lake Tahoe** to charge my credit  
(full name)

card for the permit in which I am applying, on or after \_\_\_\_\_. This payment is for

(Select one):  Building Permit  Planning Permit  Hosted Rental/QVHR Permit

at \_\_\_\_\_  
(Property Address)

Billing Address \_\_\_\_\_ Zip \_\_\_\_\_

Cardholder Name \_\_\_\_\_

Card Number \_\_\_\_\_ Expiration Date \_\_\_\_\_

CVV2 (3 digit number on back of Visa, MC, Discover; 4 digits on front of AMEX) \_\_\_\_\_

SIGNATURE: \_\_\_\_\_ DATE \_\_\_\_\_

**I authorize the above-named business to charge the credit card indicated in this authorization form according to the terms outlined above. This payment authorization is for the goods/services described above and is valid for one time use only. I certify that I am an authorized user of this credit card and that I will not dispute the payment with my credit card company; so long as the transaction corresponds to the terms indicated in this form.**